

PRODUCT CATALOG · 2026

Wood & Aluminum *Clad.*

WINDOWS & DOORS

Heritage. Craft. Performance.

PRODUCT CATALOG 2026

C
COMPEL INC.
HIGH-PERFORMANCE
WINDOWS & DOORS

Contents

2026 CATALOG

<i>01</i>	About Compel	P. 03
<i>02</i>	Certifications & Compliance	P. 05
<i>03</i>	Windows	P. 06
<i>04</i>	Hardware & Handles	P. 17
<i>05</i>	External Doors	P. 20

<i>06</i>	Internal Doors	P. 25
<i>07</i>	Custom Shop & Heritage	P. 31
<i>08</i>	Accessories — Shutters, Sills, Muntins	P. 38
<i>09</i>	Finishes — Wood & Cladding	P. 44
<i>10</i>	Architect Reference	P. 49

CHAPTER

01

About *Compel.*

IN THIS CHAPTER

About Compel

P. 04

CHAPTER 01 · ABOUT COMPEL

Compel Inc. is a Canadian business based in Rockwood, Ontario, exclusively distributing European wood and aluminium-clad windows and doors across Canada. We believe in transforming the future while honoring traditional craftsmanship — combining modern technology with artisanal skill to deliver windows and doors that exceed expectations for generations.

CERTIFIED PERFORMANCE

Engineered for the Canadian climate.

Certifications and compliance with Canadian regulations are essential to delivering windows and doors that meet the highest standards of energy efficiency, durability, and performance. Every Compel product is certified to ENERGY STAR®, Passive House Institute (PHI), and tested to NAFS — North American Fenestration Standard.

European craftsmanship — timeless design and lasting performance.

FOR ARCHITECTS *Specifications, quotes, samples, and project consultation — available on request.*



CERTIFICATION 01

ENERGY STAR® Canada

CSA A44021-25 · AAMA/WDMA 101 · NAFS



CERTIFICATION 02

Passive House Institute

PHI Certified Component · CE Certified

CHAPTER

03

Windows.

IN THIS CHAPTER

<i>Gemini Thermoclassic</i>	P. 08
<i>Thermoclassic – Specifications</i>	P. 09
<i>Gemini Passive</i>	P. 10
<i>Passive – Specifications</i>	P. 11
<i>Glass Options</i>	P. 12
<i>Casement Windows</i>	P. 13
<i>Tilt and Turn Casement</i>	P. 14
<i>Triple Glazed Windows</i>	P. 15
<i>Gallery</i>	P. 16

CHAPTER 03 · WINDOWS

*Sustainably crafted from natural materials. Superior energy efficiency, airtight performance, and a healthier indoor environment. We carry both **ENERGY STAR®** and **Passive House Institute** certified windows — the right level of performance for the project.*

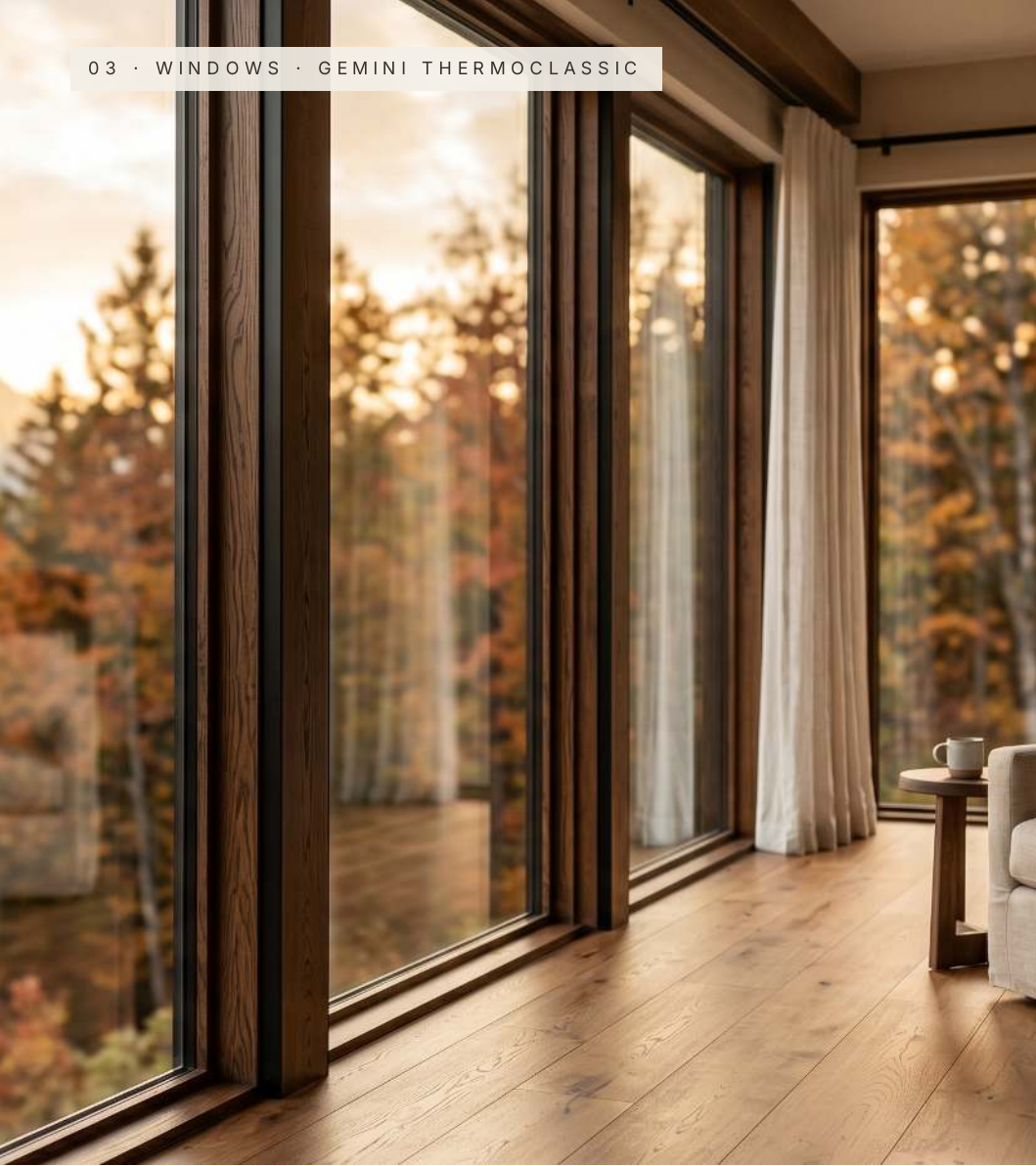

FLAGSHIP · WINDOWS

Gemini Thermoclassic.

The wood-aluminum window for everyday excellence — the warmth of timber inside, the durability of aluminum out.

Our wood-aluminum windows combine the warmth of wood with the durability of aluminum. The outer aluminum frame, made by **Aluron**, is powder-coated or anodized and available in any RAL colour. The triple-layer timber, built in the **EUROLINE 68** system, meets all Canadian standards and allows for custom window shapes.

- ▶ **Aluminum outer skin** — Aluron, powder-coated or anodized, any RAL colour.
- ▶ **Triple-layer timber core** — EUROLINE 68 system, pine / oak / meranti.
- ▶ **Custom shapes** — arches, circles, trapezoids, gothic forms.
- ▶ **ENERGY STAR® certified** · CSA A440-22 tested for the Canadian climate.

CONTINUED

Specifications & performance data overleaf →

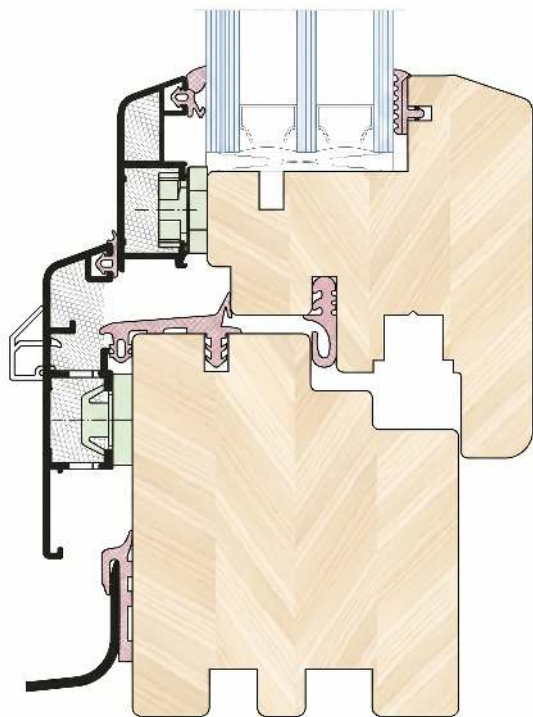

Gemini Thermoclassic

SPECIFICATIONS

AAMA/WDMA/CSA 101/LS.2/A440-22 and CSA A44021-25, ENERGY STAR Certified

Frame thickness	68.00 mm
-----------------	----------

IGU thickness	36.00 mm
---------------	----------

Overall Performance Rating LC55

Window (w)	0.96 W/m ² ·K
------------	--------------------------

Glass (g)	0.75 W/m ² ·K
-----------	--------------------------

Water Penetration Grade	720 Pa
-------------------------	--------

Air Leakage Rating	0.05 L/s·m ²
--------------------	-------------------------

Uniform Load Deflection	2 640 Pa
-------------------------	----------

Uniform Load Structural	3 960 Pa
-------------------------	----------

Forced-Entry Resistance	Grade 40
-------------------------	----------

FOR SPECIFIERS

SPEC REFERENCE (CSI)

08 51 13 – Aluminum-Clad Wood Windows

SIZE LIMITS

Operable & fixed – contact for max

TEST STANDARD

CSA A440-22 · AAMA/WDMA 101 · NAFS LC55



FLAGSHIP · WINDOWS · PHI

Gemini Passive.

PHI-certified component engineered for Passive House and net-zero construction.

Our Passive Gemini windows are **PHI-certified** and engineered for exceptional thermal performance. The timber-aluminum frame combines a pine, oak, or meranti core with high-resistance PS-foam insulation, paired with a 44 mm triple-glazed pane on a **SWISSPACER Ultimate** warm-edge spacer sealed with **DOWSIL™ 3362**.

- ▶ Pine, oak, or meranti core with high-resistance PS-foam insulation.
- ▶ 44 mm triple-glazed IGU · 4/16/4/16/4 build-up.
- ▶ **SWISSPACER Ultimate** warm-edge spacer · DOWSIL™ 3362 seal.
- ▶ **PHI Certified Component** · CE Certified · for PHI and net-zero projects.

CONTINUED

Specifications & performance data overleaf →

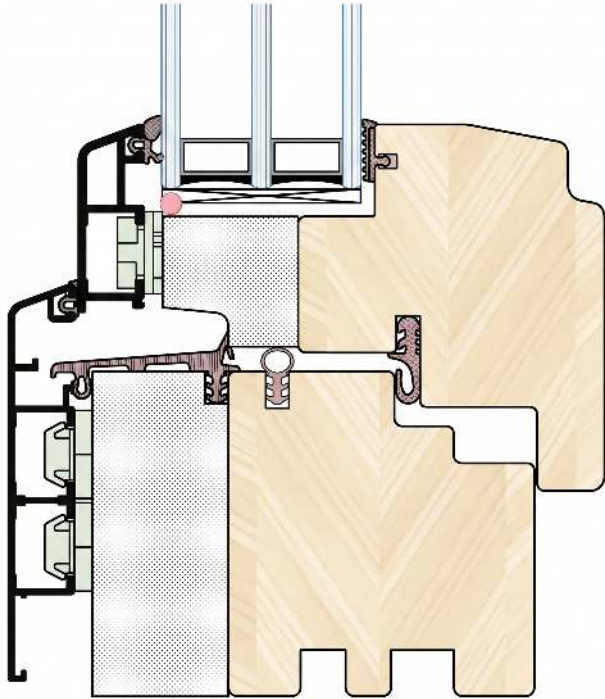

Gemini Passive

SPECIFICATIONS

UW WINDOW	FRAME	IGU
from 0.76 W/m ² ·K	92 mm	44 mm

Engineered for Passive House and net-zero construction.

Certified Passive House Component · CE Certified

Frame thickness	92 mm
IGU thickness	44.00 mm
Glazing	4/16/4/16/4

Heat Transfer Coefficient Uw

Window (w) — typical	from 0.76 W/m ² ·K
Window (w) — best (spruce, 92 mm)	0.61 W/m ² ·K
Glass (g)	0.70 W/m ² ·K
Water Tightness	Class EI200/9A
Wind Load Resistance	Class C3/B3
Air Permeability	Class 4

FOR SPECIFIERS

SPEC REFERENCE (CSI)

08 51 13 — Aluminum-Clad Wood Windows

SIZE LIMITS

Operable & fixed — contact for max

TEST STANDARD

PHI Certified Component · CE Certified

Glass Options

Every Gemini window can be specified with one of four GlasMax insulating glass units — each engineered to address a different aspect of envelope performance. All options are tested to recognised European standards and can be combined with thermal insulation as standard.



ACOUSTIC COMFORT · EN 12354

GlasMax Silent — Sound-insulating

Laminated panes with damping films, asymmetric IGU construction, and heavy gas fills attenuate noise where it cannot otherwise be reduced. Achieves airborne sound attenuation $R_w = 28$ to 53 dB depending on configuration.



IMPACT SAFETY · EN 12600

GlasMax Safe — Safety glass

Laminated construction holds the pane safely in the frame after impact — recommended for doors, balcony and terrace glazing, balustrades, and other fall-protection applications.



FORCED-ENTRY RESISTANCE · P4

GlasMax Secure — Burglar-resistant

Multiple laminated layers of glass bonded with low-stretch PVB film. Eliminates the need for external grilles or shutters while preserving the facade. Security level tailored to the spec.



SOLAR CONTROL · EN 410

GlasMax Sunblock — Solar control

Coated outer pane reduces solar heat gain in summer while retaining thermal insulation in winter. Defined by solar factor g ; the lower the value, the better the control. Available in gray, blue, and neutral tints.



BEYOND CATALOGUE · MADE TO REFERENCE

Decorative & Stained Glass

Hand-crafted decorative and stained-glass panels — designed from your reference, photograph, or original sash, and built into any Compel window or door. The custom capability behind the catalogue.

*See Custom Shop
p. 32*

Casement Windows

Casement windows are side-hinged and open inward like a door, offering excellent ventilation and unobstructed views. Their simple, elegant design suits both modern and traditional spaces, while secure locking systems provide enhanced safety.

Our windows are made from a choice of Pine, Oak, or Meranti Wood.



- ▶ **Durability** — Made for indoor and outdoor use.
- ▶ **Weather-resistant** — Performs well in varying climates.
- ▶ **Consistent quality** — Uniform texture and grain ensure a high-end, cohesive look.

FOR SPECIFIERS

SPEC REFERENCE (CSI)
08 51 15 — Casement, side-hinged

SIZE LIMITS
Single sash to spec · contact for max

TEST STANDARD
CSA A440-22 · NAFS-22



Tilt and Turn Casement Windows

Tilt and turn windows combine sleek design with versatile functionality. With a single handle, the window tilts inward from the top for secure ventilation or swings open from the side for easy cleaning and full airflow. Ideal for modern homes, they offer superior insulation, airtight sealing, and enhanced security — all in one smart, space-saving solution.

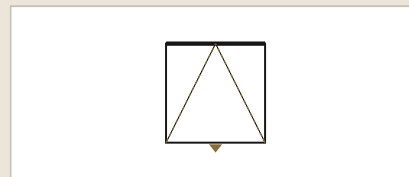

Tilt Mode

The window tilts inwards from the top, creating a small gap for fresh air to enter while keeping the frame securely locked.

- ▶ Secure Ventilation
- ▶ Energy Efficiency

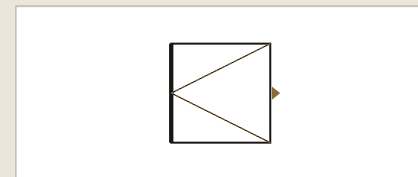

Turn Mode

The window swings open from the side, much like a casement window, providing full ventilation and effortless cleaning.

- ▶ Easy Maintenance
- ▶ Weather Resistance

FOR SPECIFIERS

SPEC REFERENCE (CSI)
08 51 15 — Tilt-Turn, dual-action

HARDWARE
ROTO NT single-handle · 10 std features

TEST STANDARD
CSA A440-22 · NAFS-22



Our wooden-aluminum windows are built with precision-engineered profiles, designed to meet modern energy and design standards.

Triple-Glazed Windows

Designed for contemporary living — combining energy efficiency, acoustic comfort, and sleek aesthetics.

- ▶ **Triple Glazing** — Three panes with thermal insulation. Standard 4/12/4/12/4* build-up; 4/16/4/16/4 on Passive systems.
- ▶ **Aluminum Frame** — Corner joints with an invisible weld to guarantee a smooth, uniform surface
- ▶ **Spacer Bar** — Improves insulation & reduces condensation
- ▶ 3 different aluminum profiles
- ▶ Compatible with Classic and Soft Life aluminum window sills
- ▶ Optional bending of sash and frame profiles to create structures with unusual shapes
- ▶ Optional aluminum frame mosquito nets (accordion style or fixed frame)

FOR SPECIFIERS

GLAZING

Triple-pane · 4/12/4/12/4 ·
4/16/4/16/4 (Passive)*

SIZE LIMITS

*Bent & curved profiles
available*

TEST STANDARD

*CSA A440-22 · ENERGY
STAR® Canada*

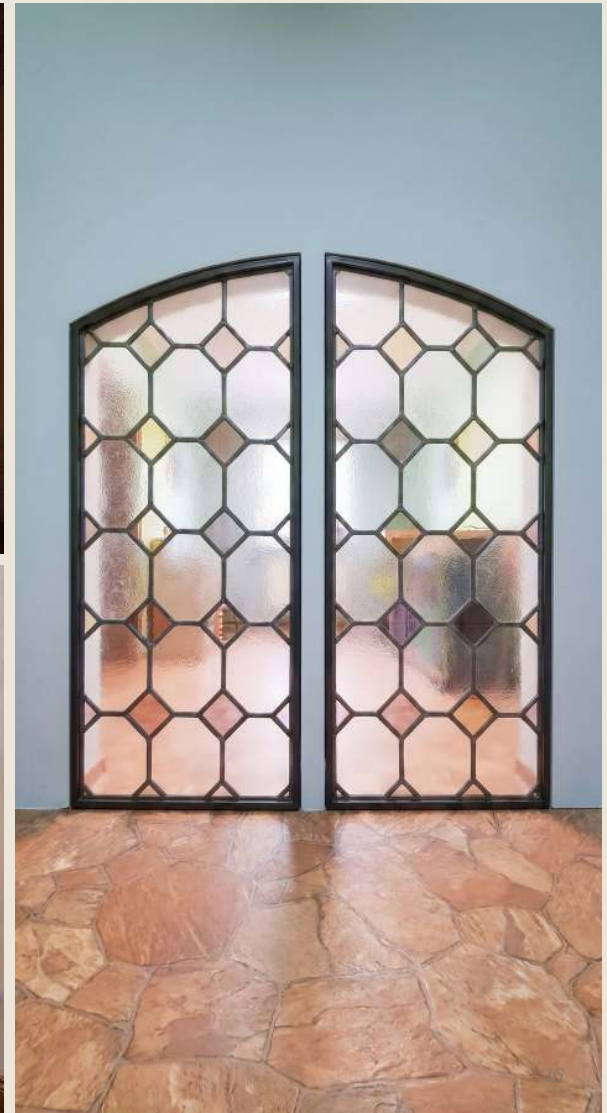

CHAPTER

04

Hardware & Handles.

IN THIS CHAPTER

ROTO Standard Hardware

P. 19

CHAPTER 04 · HARDWARE & HANDLES

Form and function — style, durability, and ease of use. ROTO standard hardware on every window. Custom finishes and profiles sourced for any door — from sleek modern lines to timeless classics.



ROTO NT

Standard wooden windows include —

Every Compel window arrives with a complete ROTO NT hardware kit. The ten features listed below are included as standard; finishes are user-specified at order — nine colours available.

01 Microventilation	02 Handle position lock with sash lifter	03 Adjustable locking pins	04 Additional stay for wide wings	05 Anti-theft corners
06 Bolt closures in double-leaf windows	07 Adjustable hinges — 130 kg load capacity	08 Two-position stay with tilt stabilizer	09 Hinge covers in one of nine colours	10 Original ROTO handle in one of nine colours

CHAPTER

05

External Doors.

IN THIS CHAPTER

Door Leaf

P. 22

Door Infill

P. 23

Gallery

P. 24

CHAPTER 05 · EXTERNAL DOORS

The entrance is a showcase. Solid wood, milled to any design, with the joinery and detailing that turn a doorway into a statement. Our external door program is built for both quality and the possibility of producing virtually any design.



Door Leaf

The door leaf is constructed with a frame made of *solid meranti 450+*, *oak wood*, or *pine wood* — each species offering its own distinctive grain. Cores are **foam-insulated** for added thermal performance and rigidity, and doors can be specified with **electronic multi-point locks** (fingerprint, keypad, Bluetooth, or Wi-Fi).



01

Solid Meranti 450+

Stable, smooth, and warm reddish in tone — ideal for precision joinery and indoor applications.



02

Oak

Naturally strong and durable, with a bold grain and timeless character that adds richness to any design.



03

Pine

Lightweight and easy to work with, with a clean, pale look. Versatile and budget-friendly across projects.

FOR SPECIFIERS

SPEC REFERENCE (CSI)

08 14 33 — *Stile & Rail Wood Doors*

CONSTRUCTION

Solid frame · meranti 450+ / oak / pine

HARDWARE

Electronic multi-point · fingerprint / keypad / BT / Wi-Fi



Door Infill

The infill is available as either an insulated cassette or glass.

Insulated Cassette: The insulated cassette enhances thermal efficiency and sound insulation.

Glass: The glass option provides a sleek, modern look with the added benefit of natural light.

ADDITIONAL OPTIONS:

- ▶ Burglary-resistant, stained glass, and decorative glazing
- ▶ Burglary-resistant hardware
- ▶ Wooden decorative elements (milled astragals, muntins)
- ▶ Glazing Bars: adhesive wooden, frame-integrated, or internal



Guaranteed Security

Engineered for enhanced security, **P4 anti-burglary glass** features multiple laminated layers that provide resistance against forced entry.



CHAPTER

06

Internal Doors.

IN THIS CHAPTER

Traditionally Opening Doors

P. 27

Lift and Slide Doors

P. 28

Multi-panel & Bi-fold

P. 29

Gallery

P. 30

CHAPTER 06 · INTERNAL DOORS

Every door affects the interior it opens into — its style needs to follow the architecture of the space. Each Compel door is built to individual order, with attention to the proportion and the tastes that make the design coherent.



Traditionally Opening Doors

Traditionally opening doors — commonly known as hinged doors — are the most standard type used for internal spaces. They operate by swinging open on hinges mounted on one side of the door frame: simple, reliable, and widely used in residential and commercial interiors.

WE PRODUCE THESE DOORS IN TWO EDGE PROFILES:

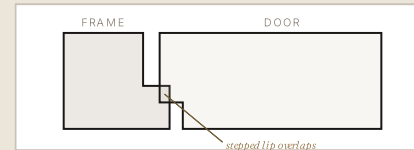

Rebated

Stepped edge overlaps the frame when closed, creating a tighter, more secure fit. Improves seal, sound, and insulation — ideal where a solid close is preferred.

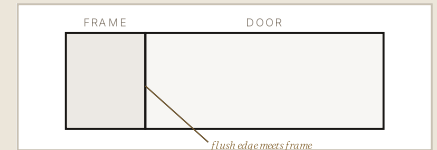

Non-Rebated

Flush, plain edge fits neatly within the frame without overlapping. Sleek, minimal appearance — favoured in modern and contemporary interiors.



Lift and Slide Doors

Sliding doors are a sleek and space-saving solution, perfect for both modern and traditional interiors. They operate by gliding along a track, allowing for smooth, effortless opening without the need for swing space. Ideal for connecting indoor and outdoor areas or dividing rooms, sliding doors maximize natural light and visibility while offering a minimalist, clean-lined aesthetic.

- ▶ Smooth track, maximum panel width of 4 meters
- ▶ Flush mount with interior floors
- ▶ Triple-glazed insulating glass across full panel
- ▶ Solid wood and aluminum-clad construction
- ▶ Multi-point locking standard

FOR SPECIFIERS

SPEC REFERENCE (CSI)

08 52 19 – *Sliding Wood-Frame Glass Doors*

PANEL LIMITS

4 m max width · panel weight to spec

GLAZING

Triple-pane · multi-point locking std



LIFT & SLIDE — MULTI-PANEL

Multi-panel lift-and-slide doors feature large glazed panels that lift off their seal and glide along a track, stacking to one side to create wide, unobstructed openings. The ideal connection between indoor and outdoor spaces — natural light, flexibility, and a modern aesthetic for patios and large living areas.



BI-FOLD DOOR

Bi-fold doors are a sleek, practical solution for open, airy spaces. Made up of folding panels, they offer seamless access and maximize natural light — ideal as internal room dividers.



CHAPTER

07

Custom Shop.

*Send us a picture.
We recreate it.*

IN THIS CHAPTER

<i>Heritage Buildings</i>	P. 33
<i>Custom Mill Work</i>	P. 34
<i>Custom Entrance Doors</i>	P. 35
<i>Everything is Possible</i>	P. 36
<i>Stained & Decorative Glass</i>	P. 37

CHAPTER 07 · CUSTOM SHOP

*Any shape, any size, any finish — we tailor windows and doors to spec.
Custom hardware sourced on request. Share an image; we engineer to
the opening; we deliver hand-built to site.*



HERITAGE BUILDINGS

Made for heritage architecture.

Compel specializes in windows and doors for heritage buildings – churches, century homes, and landmark properties whose original detailing cannot be bought off the shelf.

Working from a profile rubbing, a photograph, or the original sash itself, our European workshops reproduce the millwork, glazing bars, and arches the building was built with – engineered with high-performance standards but joined the way the originals were.

01

PROFILES MATCHED
To the original

02

ARCHES, GOTHIC
& custom forms

03

ENGINEERED TO
Current Canadian code

APPLICATIONS

Churches · Century homes · Listed properties · Restoration & adaptive re-use

Custom Mill Work

Any shape, any size, any architectural style. From classic arches and circles to trapezoidal, triangular, and gothic forms — every Compel window is built to order. The grid here is a sampling, not a catalogue. If you can draw it, we can mill it.

Twenty-four common shapes shown. The list is open.

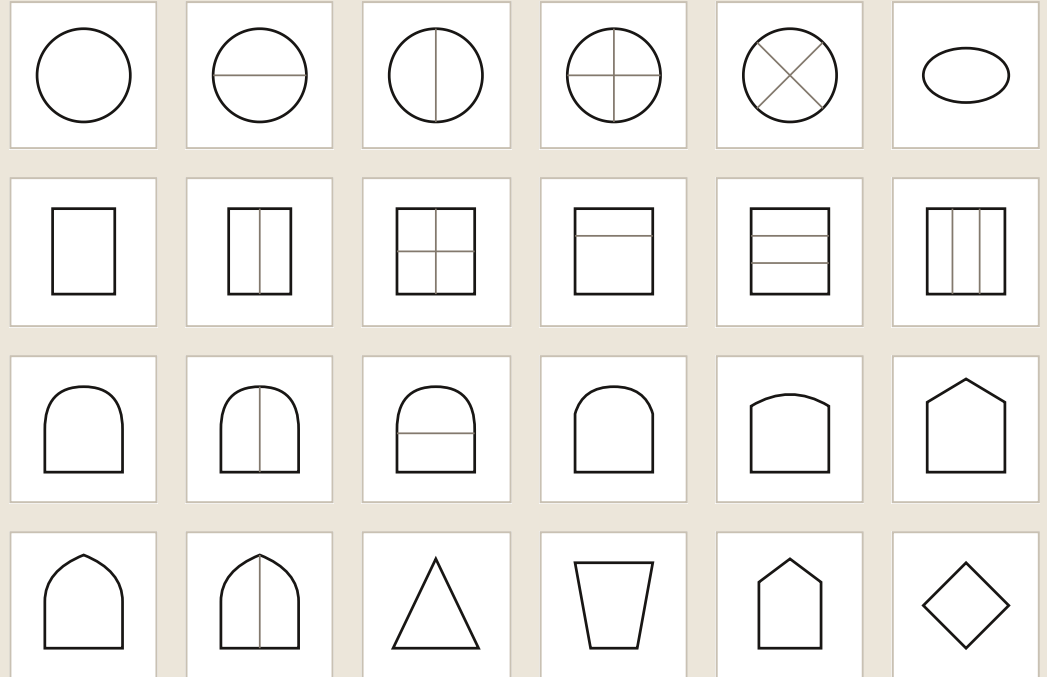

CUSTOM SHOP

Custom Entrance Doors

We create custom entrance doors that reflect your style and elevate your home. From design to installation, we work closely with you to craft a door that fits perfectly — quality materials, expert detailing, a lasting impression.

- 01 **Pick a starting profile** — or send us your own drawing, photograph, or reference image.
- 02 **Specify wood, finish, glazing, infill, and hardware** to the opening.
- 03 **We build to spec** — engineered to high-performance standards, hand-finished, and delivered to site.

Catalogue index FE202 – FE233 · thirty-two starting designs shown opposite.

FOR SPECIFIERS

SPEC REFERENCE (CSI)

081433 — Custom Stile & Rail

CUSTOM LIMITS

Any geometry · contact for opening max

LEAD TIME

Custom orders 12–14 weeks

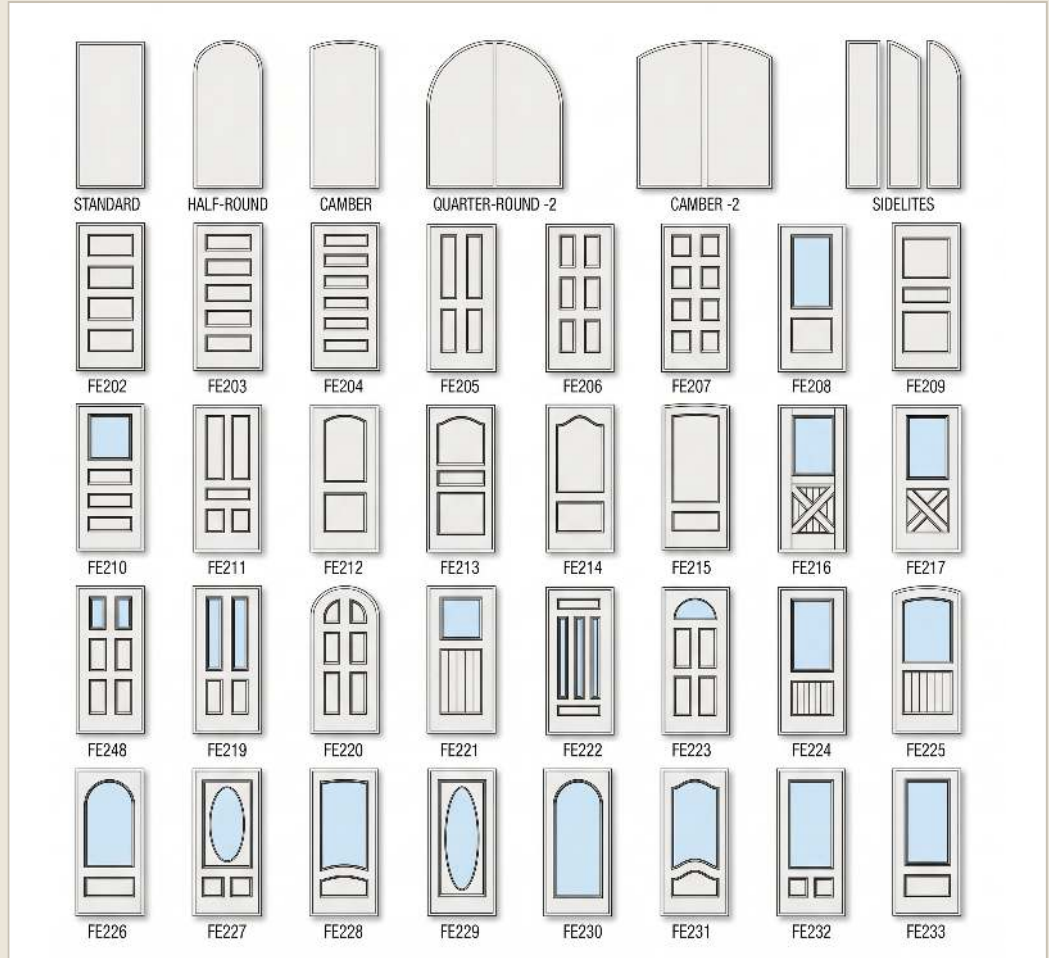

CUSTOM SHOP

*If a window has
been built before,
we can build it again.*

If it hasn't, we can be the first.

Every element of a Compel window or door is open to specification. Send us an image, an architect's drawing, or a reference — we engineer it to the opening.

INFO @ COMPELINC.CA

Form

Any shape · any size
Arches · circles · trapezoids · ovals
Bent & curved sash

Glass

Triple-glazed · low-E
Sound · safety · burglar-proof
Solar-control · stained · decorative

Detail

Muntins · any layout
Milled astragals
Decorative panels & carvings

Material

Oak · pine · meranti
Douglas fir · walnut · mahogany
Aluminum cladding · any RAL

Hardware

ROTO standard · nine finishes
Custom handles sourced to reference
Burglar-resistant locking

Operation

Casement · tilt-and-turn
Lift-and-slide · bi-fold
Fixed · pivot · rotating



CHAPTER

08

Accessories.

IN THIS CHAPTER

Wooden Shutters — Materials & Modes

P. 40

Shutters Gallery

P. 41

Window Sills

P. 42

Muntins

P. 43

CHAPTER 08 · ACCESSORIES

The elements that finish a window once the frame is in. Shutters for privacy and facade. Sills that meet both the room and the weather. Muntins that give a sash its proportion. None of them is the main event — each one is what makes a Compel installation look considered.



FOR THE PRODUCTION OF SHUTTERS WE USE:

- ▶ Meranti 450+, oak or pine wood
- ▶ Remmers varnishes that perfectly protect wood
- ▶ Roto hardware ensuring trouble-free operation

TWO MODES OF OPERATION:



Manual

Simple, reliable, cost-effective control of light and privacy — operated by hand at the sash.



Bluetooth

Wireless control from your phone — schedule, group, and operate every shutter in the house from one tap.

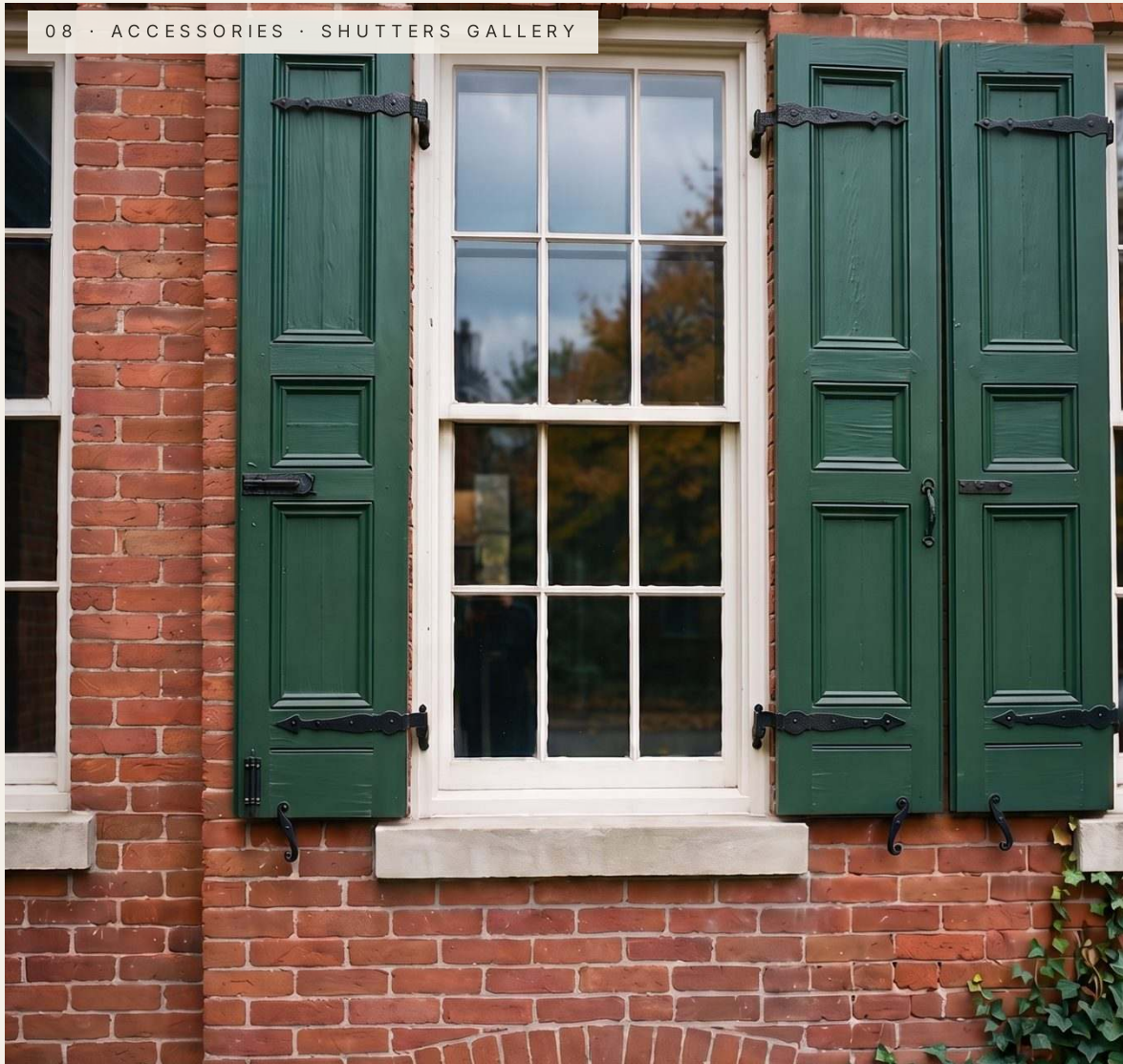



Window Sills

We offer matched interior and exterior sills for every window installation — finely finished wood inside, weatherproof aluminum outside.

INTERIOR — WOODEN

A functional surface and a finish element. Colors can match the windows or complement adjacent millwork.

Meranti 450+, oak, or pine.

EXTERIOR — ALUMINUM

Excellent durability and tightness. Includes end caps, gaskets, stainless-steel screws, and screw-cover clips.

- ▶ Widths 50 – 380 mm
- ▶ Weldable at any angle
- ▶ ~ 2 mm extruded aluminum



Muntins

Our muntins are crafted with the same precision and attention to detail as our windows and doors themselves. Designed to sit on the exterior, they measure a sturdy 26 mm, offering both structural presence and refined proportion. Each piece is engineered to complement the overall design, adding depth, character, and architectural elegance while maintaining the performance and energy efficiency of the window system.

- ▶ **Design Element:** Muntins enhance the architectural style of a building whether classic, traditional, or modern.
- ▶ **Customization:** They can be tailored in terms of layout (e.g. grids, patterns), materials, and finishes to suit design preferences.
- ▶ Matching aluminum exterior and wooden interior

CHAPTER

09

Finishes.

IN THIS CHAPTER

Wood Stains

P. 46

Aluminum Cladding

P. 47

Clad Finish Colours

P. 48

CHAPTER 09 · FINISHES

Finishes carry the building. Interior stains draw out the grain of the wood; exterior aluminum cladding seals it against weather and wear. The right pairing improves both the look of a Compel window and the life of the structure beneath.



Eight stains · two woods · sixteen pairings. Same stain reads differently on each species.

Stain Library

- ▶ **Enhances grain** — Brings out the natural texture of wood, adding depth and character.
- ▶ **Tonal range** — From the palest hemlock to deepest palisander, matched to the architecture.
- ▶ **Protection** — Adds resistance against moisture, UV, and surface wear.



Stains by Remmers — our trusted finishing partner for consistent, top-quality results.

CONSTRUCTION

A ventilated layer, by design.

Aluminum cladding serves as a durable, modern protective layer for buildings — shielding the structure from rain, wind, and sunlight. Installed with a ventilated air gap between the cladding and the main wall, the system enhances insulation, reduces moisture buildup, and improves energy efficiency. The result is a sleek, low-maintenance exterior that boosts the facade and significantly extends the lifespan of the underlying structure.

SECTION KEY

- | | | | |
|----|-------------------------------------|----|------------------------------|
| 01 | Aluminum outer skin · powder-coated | 02 | Ventilated air cavity |
| 03 | Thermal insulation layer | 04 | Wood frame / structural core |



Clad Finish Colours

We partner with **Remmers** for cladding finishes — the Deckfarbe line is durable, elastic, and weather-resistant. Long-lasting protection and beauty across Canadian seasons.

- ▶ Highly opaque
- ▶ Weatherproof and moisture-regulating
- ▶ Does not flake
- ▶ Environmentally Compatible

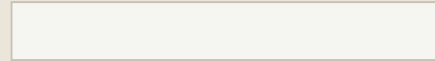

RAL 9016 (White)

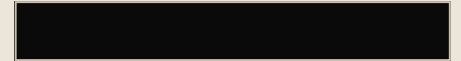

RAL 9005 (Jet Black)

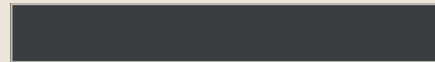

RAL 7016 (Anthracite Grey)

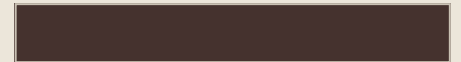

RAL 8017 (Chocolate Brown)

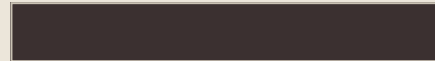

RAL 8019 (Grey Brown)

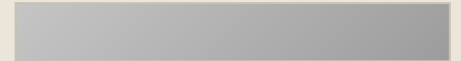

Anodized Silver

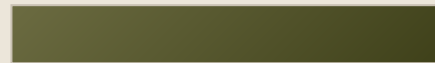

Anodized Olive

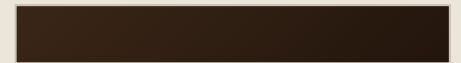

Anodized Dark Brown



Special Colours

Standards & Specifications.

The reference page: standards, units, and the process for specifying a Compel system.

STANDARDS REFERENCED

CSA A440-22 · NAFS

Canadian / North American fenestration standard. Tests Performance Grade (PG), Design Pressure (DP), water penetration, air leakage, structural load, and forced-entry resistance.

AAMA / WDMA 101 / I.S.2

North American voluntary specification for windows, doors, and skylights — the AAMA test method underlying NAFS performance class ratings (LC, CW, AW).

Passive House Institute (PHI)

Component certification for windows used in PHI-certified buildings. Tests installed U_w , frame U_f , glass U_g , and air tightness.

ENERGYSTAR® Canada

Energy-performance certification based on climate zone. Most Compel products are certified across Zones 1, 2, and 3.

EN 12554 · 12600 · 410

European standards for acoustic comfort (R_w), impact safety, and solar control — referenced by the GlasMax glazing options.

CSI MasterFormat

North American numbering system architects use to organize specifications. The "Spec Reference (CSI)" line on each product page is the section number to use in your spec book.

UNITS & CONVERSIONS

QUANTITY

METRIC · IMPERIAL

U -value $W/m^2 \cdot K \cdot 0.176 \rightarrow BTU/hr \cdot ft^2 \cdot ^\circ F$

R -value (approx) $R = 5.678 \div U \text{ } W/m^2 \cdot K$

Acoustic R_w $\approx STC \pm 1 \text{ dB}$

Dimensions $1 \text{ mm} = 0.0394 \text{ in.}$

Pressure $1 \text{ Pa} = 0.0209 \text{ psf}$

WORKED EXAMPLE

Gemini Passive U_w $0.61 \text{ W/m}^2 \cdot K$ converts to $U \approx 0.107 \text{ BTU/hr} \cdot \text{ft}^2 \cdot ^\circ F \cdot R \approx 9.5$.

HOW TO SPECIFY

01 Choose the system

Thermoclassic for general residential, Passive for net-zero or PHI projects, or custom from the Custom Shop.

02 Specify the build-up

Wood species, finish, GlasMax glazing class, cladding RAL, hardware finish, muntins.

03 Request the package

We provide quote, specifications, and project consultation.

TYPICAL LEAD TIMES

Custom orders

12–14 weeks delivered

Heritage matching

on request

TECHNICAL QUESTIONS

info@compelinc.ca

PHYSICAL SAMPLES

Wood, stain, & cladding on request

PROJECT CONSULTATION

+1 (416) 707 9187

PRODUCT CATALOG · 2026



GET IN TOUCH

*Let's build
something lasting.*

TELEPHONE

+1 (416) 707 9187

WEB

www.compelinc.ca

ROCKWOOD, ONTARIO · CANADA

EMAIL

info@compelinc.ca

INSTAGRAM

[@compelinc](https://www.instagram.com/compelinc)